

GREYSTONE®

INSTRUCTION MANUAL
Gas Hob

Models:

CF-RVHOB17/CF-RVHOB17B

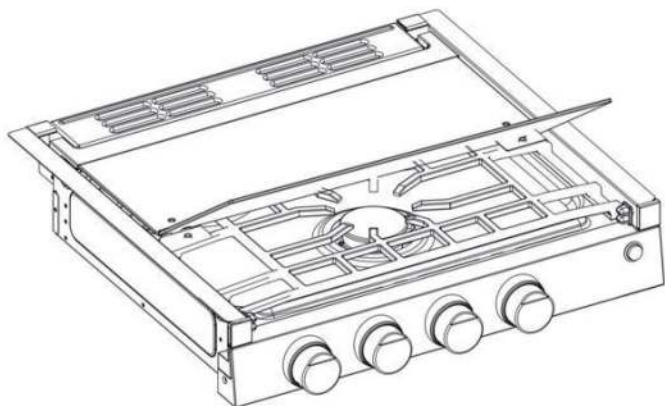

Table of Contents

Product Introduction.....	3
Safeguard Measures.....	3
Instructions for safety.....	5
Installing your appliance.....	8
Function.....	12
Hob Features.....	16
Product Troubleshooting.....	18
Sanitation&Upkeep.....	19
Exploded-View Drawing.....	20
Product Warranty Information.....	22

Product Introduction

Thank you for your purchase of the Greystone Gas Hob! before the use of your new Greystone Gas Hob, please review this users manual carefully. This user and instruction guide contains useful information pertaining to safety, maintenance/upkeep, installation, functions, features, and warranty.

Please do not dispose of this user manual , as you may need to refer to this guide in the future. If you should ever need to pass this user manual to any future owner of the gas hob, please do so. By following the information in this users manual could reduced the risk of injury and will provide information for safety use.

If these instructions are now followed in anyway, Greystone does not accept any responsibility for injury or damage.

Safeguard Measures

 **WARNING:** This symbol indicates a safety alert, it will alert you to possible hazards that can cause serious bodily harm, property damage or even death. The safety symbol will precede important messages about safety.

WARNING: If one does not follow the instructions in this guide exactly, an explosion or fire may result in personal injury, property damage, or even death.

Do not use or keep storage of flammable substances; such as gasoline, or any other flammable substances or liquids; near this product or any appliance.

IN THE EVENT THAT A GAS SMELL IS PRESENT:

- Do NOT attempt to ignite or light ANY appliance or incendiary device
- Do NOT touch ANY electrical switch
- Do NOT use any phone or electrical device in your recreational vehicle
- Evacuate the recreational vehicle of all occupants and pets
- Shut off the main gas supply or gas tanks supply valve
- From a location away from the gas smell and recreational vehicle, call your gas supplier immediately for further instructions.
- If your gas supplier can not be reached, proceed to call the local fire department or 9-1-1 immediately.
- Have the gas hob and system checked and have the leakage source solved by a qualified installer, manufacturer or dealer, the gas supplier, or a service agency.

Caution

Caution: Hazards or unsafe practices CAN result in minor personal injury or harm.

Read the following instructions carefully before attempting the following application to prevent the potential risk of electric shock, fire, damage to the appliance or personal injury. Please use appliance only for its intended purpose as described by this manual.

If you are using an external electrical source please ensure that the appliance is electrically grounded in accordance to state or other codes such as the National Electric Code (NFPA70/AN51). Do NOT attempt to repair, adjust, service, or replace any parts on your appliance, unless specifically recommended by this manual. Other services should be referred to a qualified service technician.

The warning and important safety instructions appearing in this guide are not meant to cover every condition and possible situation that may occur. Caution, common sense and care must be practiced when maintaining operating, or installing your appliance. One should always contact the manufacturer about conditions or problems you do not understand.

Instructions for safety

- Before using this appliance one should remove all tape and packaging. Destroy the carton and plastic bag after unpacking the appliance, please dispose of this properly, and never allow children to play with the packaging material.
- This appliance should be installed properly by a qualified technician, in accordance with local and state regulations and law.
- Never modify or alter the appliance by removing screw, anti-tip brackets, level-ing legs, panels or any other part of the product.
- Do not store objects that could be of interest for children in the cabinets above the appliance. A child could attempt to climb onto the appliance to reach these items and could be harmed or seriously injured.

WARNING

Do NOT use this hob as space heater to warm a room, as this may cause carbon monoxide poisoning and overheating the hob. Never cover the rack completely with materials like aluminum foil or any other flammable objects. Doing this can cause an air flow block; carbon monoxide poisoning, fire, or explosions may occur as a result.

- The cooktop must be separated from the gas supply piping system by closings its manual shutoff valve during any pressure testing that equal to or less than 1/2psi(3.5KPa).
- Do NOT touch surface burners, space near these burners.

During and after use, do NOT touch or allow flammable materials, objects, or clothing to touch or come into contact with these areas until they have cooled down. Any burners; may be hot even though flames are not visible. These burners may still be hot enough to inflict burns or injuries.

- DO NOT wear loose fitting or clothing that hangs while operating this hob, as these items could catch fire and cause serious injury or property damage.
- When heating grease, oil or fat, watch it closely. Oils, fats, or grease can catch fire if they become too hot. In the event of a grease or oil fire, smother the fire with the pan lid, use baking soda, or a dry chemical, or foam type fire extinguishers. **DO NOT USE WATER OR FLOUR!**
- The space in which the hob is be installed into should be constructed so that the hob is framed in and guarded to prevent creation or storage space around the hob.

WARNING

Gas leaks may occur in the system and result in dangerous conditions. In some situations, a gas leak may not be detectable by smell. Gas suppliers recommend you purchase and install a UL approved gas detector. These detectors should be installed in accordance to the manufacturers instructions.

Do NOT use wet or damp potholders, only use dry potholders. Do NOT let the potholders touch hot or heating burners. Do NOT use a towel or other bulky cloth in place of a potholder.

Do NOT heat unopened food containers as the pressure of heat or steam could buildup, this may cause the container to rupture or explode and could cause harm or serious injury.

CAUTION: Never attempt to utilize the hob during a power failure. During the event the power fails during use, always shut off the hob, as your appliance may turn on unsupervised as the power restores.

Instructions for cooktop usage:

- Using the correct flame size: Flame should be adjusted so that it does not exceed beyond the edge of your utensils such as a pot or pan. Undersized utensils may expose a portion of the burner and flame, they may result in the combustion of fabric or clothing if they make contact with the flame. Using correctly sized pots or pans will improve efficiency and safety.
- Do not use stove top grills on a sealed gas burner, doing so may cause incomplete combustion and this may result in carbon monoxide poisoning.
- Please memorize the knobs and their corresponding burners which they control. Always place a pan on the burner before starting a flame. And always turn off the burner before removing pan.
- Always turn the knob all the way to the “Light” mark when igniting the top burners, always then check to see if flames are visible, ensuring that the burner is then lit.
- Do NOT face pot or pan handles outward, they should always be facing inward but not directly over another flame. This practice can reduce the risk of serious burns, spillage, or even the combustion of flammable items or materials; in the event there is accidental contact with the handle.
- Do NOT leave the top burners on a high heat setting unattended, the failure to supervise can result in a boil over which can cause smoke, or a grease fire.
- **Protective Sheets:** Never use aluminum foil to cover the burner pans, unless suggested by this manual. The improper use or

installation of these sheets and liners can increase the risk of electrical shock or fire.

- **NEVER use a searing grill on cooktop:** searing grills are not designed for use on this hob, the utilization of a searing grill can cause a fire.
- **NEVER USE A DECORATIVE BURNER COVER:** In the event that a burner is turned on accidentally, the covers could become too hot, could possibly melt or combustion. The can also result in damage to the hob from overheating and can cause ignition and combustion problems.
- **Cooking utensils that are glazed:** please only use certain types of ceramic, glass, or glazed utensils that are designed for use on a cooktop. Avoid the use of these utensils when possible.

Cleaning Instructions

You should always clean your cooktop regularly, and keep all parts grease free to prevent fire: Clean all grease filters and exhaust fan vents. Never allow grease to build up on filter or hood, grease buildup could ignite. Turn on hood fan when cooking under hood.

Installing your appliance

The installation of your cooktop **MUST** conform with state or local laws and codes, in the absence of codes and laws, please use the standard for RV's (NFPA 1192/AN51)

WARNING

When installing this cooktop, you must adhere to the written instructions in this guide. No representative, agent, or employee of the manufacturer of GREYSTONE or any other person(s) has authorization to do any kind of modifications, provisions/edits, or changes to the instructions mentioned in this users manual.

CABINET SPECIFICATIONS

To ensure proper operation of your cooktop, suitable cabinets must be used.

Cabinet specification information:

- There must be a ventilation hole in the cabinet for air circulation. A gap at the bottom of the cooktop, with a minimum of 3/8", will also provide proper air circulation.
 - The minimum vertical distance from the cooking top is 30". To reduce distance use non-combustible materials and construction can reduce the distance required.
 - If cabinets are installed above the cooktop, the maximum depth is 13". If the hood is below the cabinet, there is no limitation for the cabinet depth.
 - The minimum distance between the vehicle/trailer floor and bottom of the cut out is 4". The minimum distance from the top of the cooking grate to the charcoal filter on the range hood is 19.5".
 - The minimum horizontal distance from the rear wall will be no more than 9" adjacent to the vertical combustible wall.
 - The minimum horizontal distance from the side wall will be no more than 7.25" adjacent to the vertical combustible wall.
- All measurements are distances from the center of the burner, out**

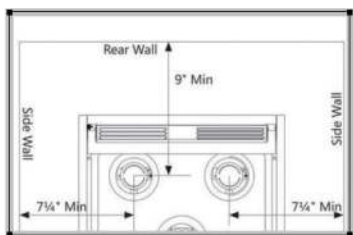

Cabinet and counter cutout:

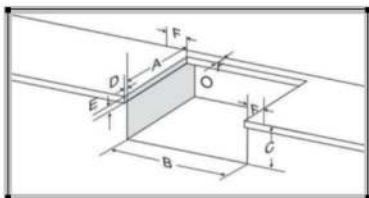

Model	A	B	C	D	E	F
17" RVHOB	17.75" 451mm	20.25" 514mm	4.13" 105mm	0.94" 23mm max.	1.56" 40mm max.	2" min 51mm min.
Above is the minimum cutout size						

How to Install Gas hob:

Once the gas line is in place and the cabinet has been prepared in accordance to the dimensions previously provided:

1. Remove packing material, tape and any temporary labels from your hob. (Fig. 1)

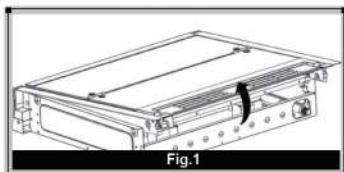

2. Push back the top glass cover assembly a little and lift up to remove it from the hob. (Fig. 2)

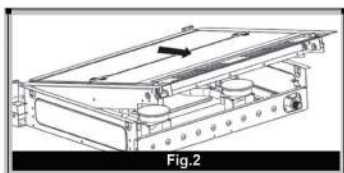

3. Slide the hob into the cabinet opening. Verify the hob is level from side to side and front to rear. (Fig. 3)

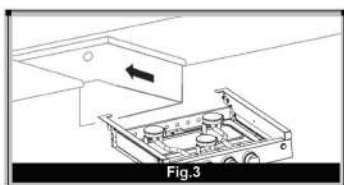

4. Connect a gas supply line with a shut-off valve and 5/8-18UNF connection to the hob through gas cavity on the upper Left-rear corner of the cabinet. Connect a 12V power supply wire to the appliance from the upper right-rear corner of the cabinet. (Fig. 4)

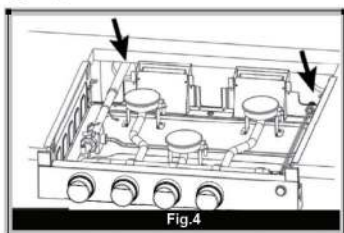

5. Use four tapping screws on both left and right to secure the hob (Fig. 5)

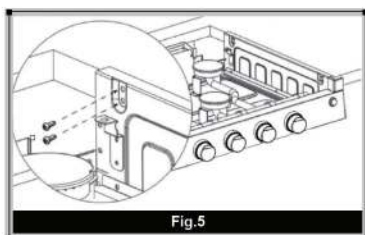

6. Check the pipe fittings for leaks using a soapy solution. NEVER TEST FOR LEAKS WITH OPEN FLAMES!

7. Push to insert the top glass assembly. (Fig. 6&7)

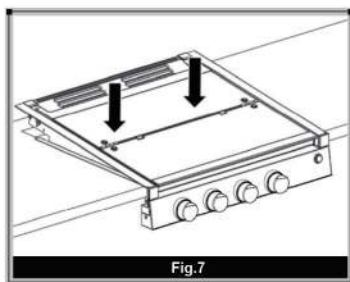
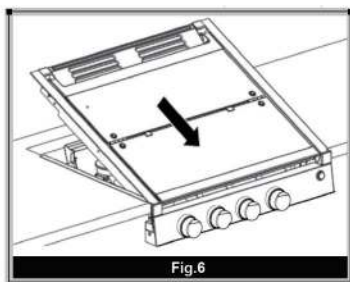

8. The hob is completely installed into the cabinet. (Fig. 8)

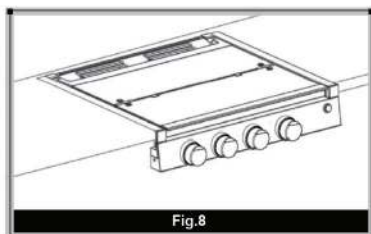

Electrical Connection

Model with LED light: Connect the light wires to a 12V DC circuit with a fuse protected and a max rating of no more than 5 amps.

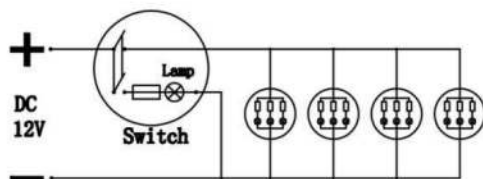

Wiring Diagram

Function

How to Light Top Burners

⚠ WARNING

Top cover must be open when main burner is in operation. Based on safety considerations, the top burner flame size should be adjusted so it does not extend beyond the edge of the cooking utensil.

Lighting TOP burner with match:

1. Make sure and check that ALL knobs are turned to the OFF position before lighting with match
2. Ensure the main gas valve is in the open position
3. Rotate the appropriate burner knob counterclockwise to "HI" position. (Fig. 9)

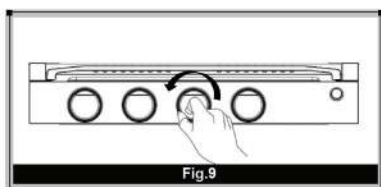

4. PROMPTLY position an extended lit wooden match, or use an extended butane lighter, through the grate spaces, nearest the burner port, to light the burner. Repeat steps 4 & 5 to light desired burners (Fig. 10)

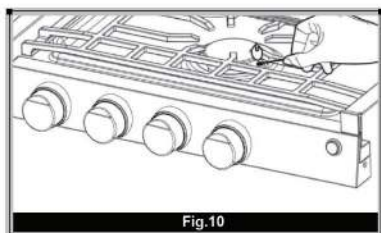

5. To Adjust to the desired flame, push and rotate the burner control knob (Fig. 11)

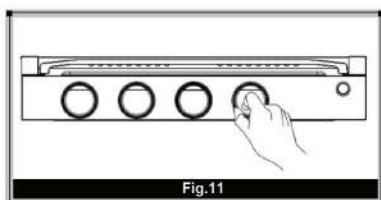

Igniting Gas Hob Electronically:

1. Ensure all control knobs are in their OFF positions
2. Ensure the main gas tank valve is ajar
3. Turn the desired control knob counterclockwise to HI setting, DO NOT LIGHT more than one burner simultaneously
4. Immediately after the control knob is set, turn the ignition knob clockwise multiple times or until the burner lights.

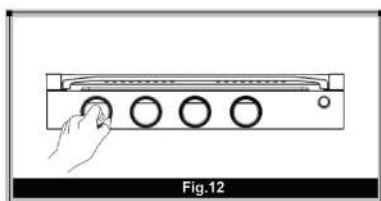

Turning the gas hob flame OFF:

To turn the burner flame off, push and turn the control knob clockwise until the knob is in the OFF position. If you travel and need to refuel your gas tank, ALWAYS turn the tank valve off.

Useful information on proper flame for burner: Gas burners will tend to burn blue, if the ration of fuel to air is adjusted properly.

Burner flames that burn yellow on the tip of the flame (over 1 inch) is a sign that the burner is not receiving enough air for the combustion of gas. If the tip of the flame, is more yellow in appearance, this could indicate that the burners air shutter (or Venturi) needs to be adjusted, so that they can produce more air. Please be aware of any carbon or soot deposits that may build up on the burner as this too will affect the burners ability to cook evenly and properly.

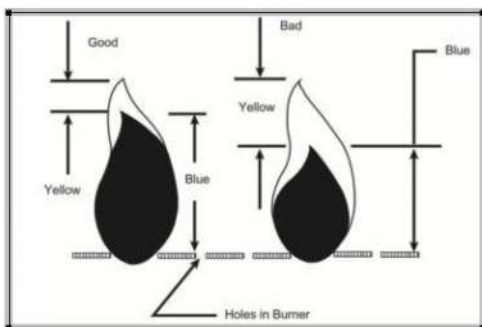

LED Light

Press the button to manually turn the knob light on/off.

ALWAYS PREFORM A GAS LEAK CHEACK BEFORE USING GAS HOB! Before operating the gas hob, always preform an analysis or check for a gas leak. DO NOT use gas hob until the leak test is preformed and confirmed there are no gas leak indications. Test for leaks by using between 11-13.8 WC pressure.

- if there is a gas leak detected, replace the defective part recommended by the manufacturer or tighten the loose joint properly

WARNING

BEFORE TESTING FOR GAS LEAK

1. Ensure gas hob controls are in their OFF positions.
2. Never test for leaks with any open flames present
3. Do not smoke when testing for gas leaks
4. Use a soapy solution to detect gas leaks. If there are bubbles present, there is a gas leak.

WARNING

MERCHANDISE HARM RISK!

! If the control knob is set to the LIGHT position, DO NOT COOK as damage may occur to the ignition module and the burner electrodes

! DO NOT LET children or pets play near, at, or around gas hob. Be cautious as cooktop can tip/fall if pulled. ALWAYS check cooktop before setting temperature.

! DO NOT USE cookware that exceeds 1 inch larger than the burner grate. If oversized cookware is used, this may cause extreme heat build-up and may result in destruction to the burner grate, burner, and/or cooktop (maximum pan size= 10 inches)

! DO NOT USE any cooking pan, griddle, or any cooking instrument that covers more than one burner at any time. Maximum pan size is a 10 inch skillet. Any cooking instrument larger than 10 inches, is strictly prohibited. If this instruction is not followed, results may cause large amounts of heat that could result in the liquefying of the item or could result in damage to the burner grates or cooktop.

! Leaving an empty or boiled dry cooking utensil on a hot burner, could result in damage to the cooking utensil or could result in serious damage and/or fire. Remove all pans/cooking utensils, when not in use.

Hob Features

Optional power	Gas power
	Left and Right Burner: 6500 BTU
BTU/HR	Front Burner: 8000BTU
Fuel / Power	Propane
Inlet Pressure	10" WC Min to 13.8" WC Max
Power Input	12V DC <2 Amp '

This appliance conforms to the directive: ANSI Z21.57-2010 Recreational Vehicle Cooking Gas Appliances, ANSI Z21.57a-2012 Addenda to Recreational Vehicle Cooking Gas Appliances, CAN1-1.16-M79 (reaffirmed 2016) Propane Cooking Appliance For Recreational Vehicles.

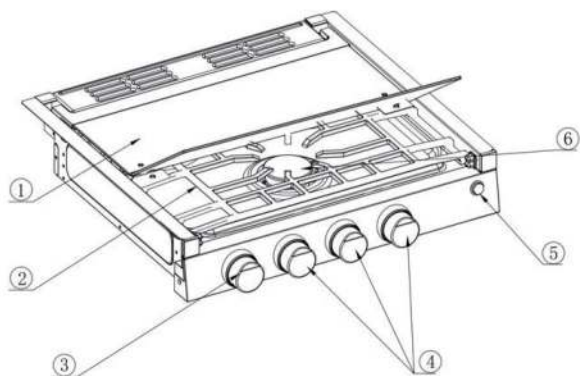

①	Glass Cover
②	Grill
③	Ignition Knob
④	Top Burner Control Knob
⑤	Backlight
⑥	Burner

Product Troubleshooting

PROBLEM/SYMPTOM	POSSIBLE CAUSE/SOLUTION
Area surface burners will not ignite or area surface burners do not ignite uniformly	Surface control knob has not been fully rotated to the LIGHT position.
	Check to see if gas valve is open. If not, open it.
	Burners are clogged. Make sure burner is off. Use a small wire, toothbrush or needle to clean burner ports and slots.
	Low gas level in tank. Refill or replace gas tank.
	Low battery power. Replace AAA battery which is under igniter cap.
	There is moisture on the burner. With burner off, dry burner thoroughly
Surface burner flame is yellow or orange instead of blue	Debris may be present in gas line. Let burner run for a few minutes to see if flame changes to blue.
	Humid air in the home, sometimes caused by running a humidifier, may cause flames to be burn yellow.

Sanitation & Upkeep

- Ensure all control knobs are in OFF position before cleaning.
- Ensure the cook-top and all components relating to the gas hob are cooled off before touching or cleaning.
- When cleaning the cooktop, only use an hobcleaner specifically designed for hobs. Ensure proper usage of the hobcleaner by following the hob cleaners instructions thoroughly.

If there is a spill on the cook-top, grate(s), burner caps, or any other component of the gas hob, clean the spill right away (make sure the cooktop is cooled off) as leaving any spill can result in the discoloration or staining of your cooktop or stainless steel.

- Always use caution when cleaning, especially around the burners. If caution is not used, you may catch the metal igniter electrode on your cleaning item (such as your sponge or washcloth, etc.) which can damage or break the metal igniter electrode. If the metal igniter electrode is damaged , the igniter may not ignite.
- If you wish to clean or wash porcelain surfaces, you must allow the areas to cool beforehand. Hot porcelain can crack and can also burn flesh.
- The best way to clean the cook-top porcelain surfaces, stainless steel surfaces, painted surfaces, burner grates, plastic items, or any other items relating to the gas hobs to use a mild soapy water solution.

THE DO NOT's OF SANITATION AND UPKEEP:

- DO NOT USE bleach.
- DO NOT USE rust removers.
- DO NOT USE steel wool, only use non abrasive pads; such as the soft side of a sponge or a soft washcloth.
- DO NOT USE any abrasive, gritty, or acid-type like cleaners.
- DO NOT BLOCK movement of combustion a.k.a air ventilation.

- DO NOT STORE flammable liquids or vapors (such as gasoline) or any other combustible equipment or materials near, at , or around the gas hob.
- DO NOT USE any metallic or wire brush to clean any components relating th the cooktop. Some wire or metallic brushes those their bristles and these bristles could get stuck in the burner ports or other small crevices and could result in a explosion or a fire.
- DO NOT ALLOW food that contains acids such as: vinegar, citrus juices (lemon, lime, grapefruit, etc) tomatoes, etc. to remain on any painted, porcelain, cook-top, grates, or any other surface relating to the gas hob. Some acids react to the paint and gloss that is used. If an egg spill should occur, clean the egg spill when cook-top has cooled down, do not allow the egg spill to remain on surface.

Exploded-view Drawing

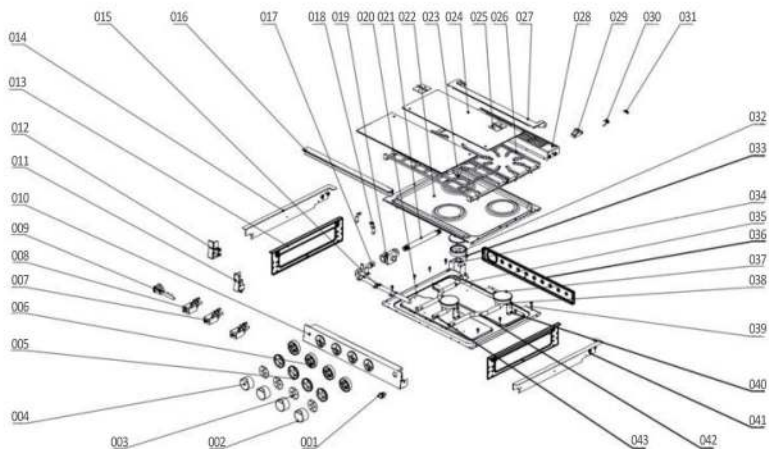

001	Lamp Switch
002	Knob
003	LED PCB
004	Igniter Knob
005	Decoration Ring
006	Knob Base
007	Front Burner Valve
008	Rear Burner Valve
009	Igniter
010	Control Panel
011	Control Panel Holder (Right)
012	Control Panel Holder (Left)
013	Side Panel
014	Decoration Bar Left
015	Gas-in Pipe Holder
016	Glass Cover Fixer (Front)
017	Inner Chamber Front Plate
018	Gas-in Pipe Holder
019	Regulator
020	Insulation Plate
021	Rear Gas-in Pipe
022	Working Table
023	Front Pan Support Grill
024	Glass Cover
025	Glass Cover Hinge
026	Rear Pan Support Grill
027	Glass Cover Holder (Rear)
028	Chimney Decoration Panel
029	Glass Cover Axis Holder
030	Glass Cover Spring

031	Nut
032	Fire Distributor
033	Front Burner Ignition Pin
034	Mica Sheet
035	Left Burner Pipe
036	Rear Plate
037	Burner Cover
038	Rear Burner Ignition Pin
039	Grill Silicon
040	Burner Holder
041	Decoration Bar Right
042	Right Burner Pipe
043	Front Burner Pipe

Product Warranty Information

Your GREYSTONE appliance is covered by a one-year limited warranty. For one year from your original date of purchase of the original purchaser, GREYSTONE will pay costs for repairing or replacing any parts of this appliance that prove to be defective in materials or workmanship when such appliance is installed, using and maintained in accordance with the provided instructions.

Exclusions

This warranty does not cover the following:

1. Products on which original serial numbers have been removed, can not be determined, or altered in any way
2. Product that has been transferred from its original owner to another party. Product has been removed outside of the USA or Canada
3. Rust on the interior or exterior of the unit.
4. Products that have been purchased secondhand.
5. Commercial use of product.
6. Service calls which do not involve malfunction or defects in materials or workmanship, or for appliances not in ordinary household use or used other than in accordance with the provided instructions.
7. Service calls to correct the installation of your appliance or to instruct you how to use your appliance.
8. Expenses for making the appliance accessible for servicing, such as removal of trim, cupboards, shelves, etc., which are not a part of the appliance when it is shipped from the factory.
9. Service calls to repair knobs, buttons, handles, or other cosmetic parts.
10. Surcharges including, but not limited to, any after hour, weekend, or holiday service calls, tolls, ferry trip charges, mileage expense for service calls to remote areas, including the state of Alaska.

11. Damage to the finish of appliance, RV, or home incurred during installation, including but not limited to floors, cabinets, walls, etc.
12. Damage caused by services performed by unauthorized service companies, use of parts other than genuine GREYSTONE parts or parts obtained from persons other than authorized service companies, or external causes such as abuse, misuse, inadequate power supply, accidents, fires, or acts of God.

The customer's sole or exclusive remedy under this limited warranty shall be product or repair or replacement as provided herein. Claims based on implied warranties, including warranties of merchantability or fitness for particular purpose, are limited to one year or the shortest period allowed by law, but not less than one year. GREYSTONE shall not be liable for consequential or incidental damages such as property damage and incidental expenses resulting from any breach of this written limited warranty or any implied warranties, so these limitations or exclusions may not apply to you. This written warranty gives you specific legal rights. You may also have other rights that vary from state to state.

Proof of purchase may be required for warranty purposes. If service, of any kind, is performed please obtain and keep all original receipts. Product features or specifications as described or illustrated are subject to change without notice.

GREYSTONE



WAY

Interglobal Network

For further information, please contact:

Way Interglobal Network, LLC
3002 Coast Ct
Elkhart IN 46514

(574) 971-4490

Hours: Monday- Friday
7:30 a.m. -4 p.m. Eastern Time
Closed Saturday- Sunday

GREYSTONE is a registered Trademark of Way Interglobal Network, LLC